



## F40

Rotomoulded HDPE bowl  
with full metal protection.



Full hot dip galvanised steel protection:  
avoids nibbling.

Ref. 30-65 F40  
EAN 13 3599150043243



### Non-spill and chew resistant drinker

- ▶ The rim of the HDPE bowl is entirely protected by a non-spill edge avoiding water spillage by the animals.
- ▶ With its large bowl dimensions (L 404 x W 262 x H 120 mm) the F40 is the perfect drinker to be installed between two pens for a higher drinking comfort of your cattle.
- ▶ A set screw allows increasing the flow rate up to 20 l/min without disassembly and the tube with jet breaker delivers a gentle flow of water.
- ▶ Connected to a SPEED-FLOW circulation pump, the A-369 circulation set keeps the valve of the F40 and its water lines frost-free.

### Sturdiness for a longer service life

- ▶ Shock resistant rotomoulded HDPE. The rounded shapes avoid injuries to the animals.
- ▶ The full hot dip galvanised steel protection avoids nibbling.

### Ease of installation and maintenance

- ▶ The F40 can easily be installed against a wall, on an I-shaped or round post (with A-331 bracket).
- ▶ The 3/4" brass valve allows multidirectional water connection.
- ▶ The Ø 30 drain plug can be removed without tools for quick and thorough cleaning.

## Accessories

Mounting bracket for Ø102 mm post and octagonal post.



Ref. A-331 Mounting bracket

Circulation set to keep valve and water lines frost-free.



Ref. A-369 Mounting set for connection to a circulation system

## Dimensions

Front

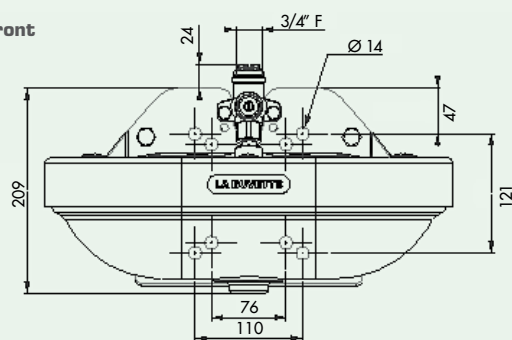

Top

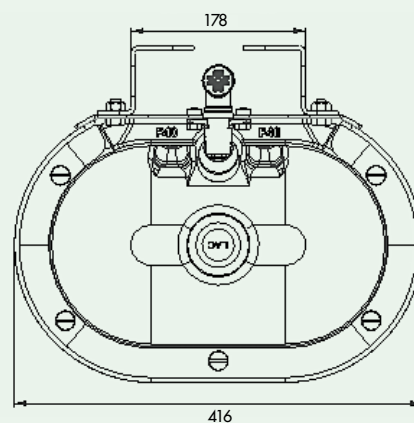

Side

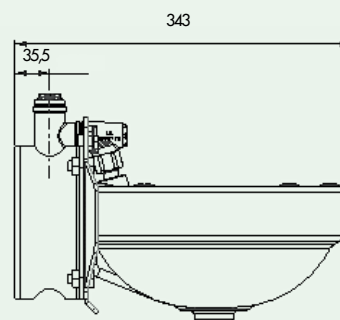

Visit our website: [www.labuvette.com](http://www.labuvette.com)

Rue Maurice Périn • Parc d'Activités Ardennes Émeraude • Tournes • F-08013 CHARLEVILLE-MÉZIÈRES Cedex

Tel.: +33 324 52 37 23 • Fax: +33 (0)3 24 52 37 24 • Email: [commercial@labuvette.com](mailto:commercial@labuvette.com)